

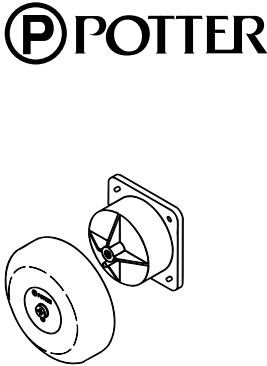

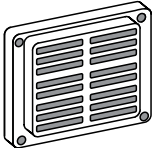

Bells, Horns & Strobes

FFF Number	Mfg. Number	Description	Pack	POTTER
<p>ALARM BELLS Used to assist the fire department in finding the building as well as to alert the occupants that there is a fire through the use of a high decibel vibrating bell. Steel gong, aluminum casing, red bell.</p>				
521106	PBA1206	6" 120 VOLT ALTERNATING CURRENT	1	
521110	PBA12010	10" 120 VOLT ALTERNATING CURRENT	1	
521116 521111	PBA246 PBA2410	6" 24 VOLT DIRECT CURRENT 10" 24 VOLT DIRECT CURRENT	1 1	
<p>Alarm Horn Used to assist the fire department in finding the building as well as to alert the occupants that there is a fire through the use of a high decibel horn. Die cast metal casing.</p>				
522130 522134	FH-120 6170	120 VOLT ALTERNATING CURRENT 120 VOLT ALTERNATING CURRENT-FLUSH MOUNT	1 1	
<p>Alarm Horn/Strobe Combination Used to assist the fire department in finding the building as well as to alert the occupants that there is a fire through the use of a high decibel horn and an 8,000 peak candlepower strobe light. Die cast metal casing, polycarbonate lens.</p>				
522132	FHS-120	120 VOLT ALTERNATING CURRENT	1	
<p>Alarm Horn/Strobe/Sign Combination The SASH series is a multitone horn/strobe combination designed for use as an audio/visual indication for automatic sprinkler systems. It can be installed in conjunction with or in place of water motor gongs. Can be used for both indoor or outdoor applications.</p>				
522138 522139	SASH-24 SASH-120	24 VOLT ALTERNATING CURRENT 120 VOLT ALTERNATING CURRENT	1 1	
<p>Water Motor Sprinkler Alarm The water motor alarm is a waterproof, hydraulically driven mechanical bell (gong), that automatically sounds a continuous alarm when the sprinkler system activates. The gong is closely fitted to the shroud assembly, eliminating the need for a gong cover or special guard.</p>				
533271		MECHANICAL SPRINKLER ALARM	1	
<p>Weatherproof Back Box Provides a weather proof enclosure for wiring. Works with all alarm bells. Die cast metal, painted red. Indoor / Outdoor.</p>				
521150	BBK-1	4-21/32" X 4-21/32" X 1-1/2" DEEP	20	
<p>Bell Cage Protects bell from damage or being sound deadened by an obstruction. Painted red.</p>				
521160		FOR 6" TO 10" BELLS	1	

Flow Switches

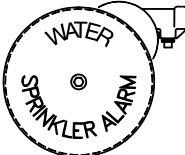
FFF Number	Mfg. Number	Description	Pack
FLOW SWITCHES			
Pressure Type			
For monitoring dry systems or wet systems using alarm check valves. Field adjustable between 4 and 20 PSI.			
522104	PS10-1A	1/2" MIP WITH ONE S.P.D.T CONTACT	1
522105	PS10-2A	1/2" MIP WITH TWO S.P.D.T CONTACTS	1
High / Low Pressure Type			
Designed primarily to detect a 10 PSI increase and/or decrease from normal system pressure. Field adjustable between 10 and 175 PSI.			
522110	PS40-1A	1/2" MIP WITH ONE S.P.D.T. CONTACT	1
522112	PS40-2A	1/2" MIP WITH TWO S.P.D.T. CONTACTS	1
Vane Type - Threaded Connection			
For use in wet sprinkler systems with small diameter pipe that do not have an alarm check valve. Service pressures up to 250 PSI. Each unit contains two single pole, double throw, snap action switches and paddles for 1", 1-1/4" and 1-1/2" pipe sizes.			
522200	VS-SP	1" IPS	1
RESIDENTIAL FLOW SWITCHES			
Vane Type - With Retard and "Threaded" Union			
The Model VSR-SFT is a vane type waterflow switch for use on wet sprinkler systems that use 1", 1-1/4", 1-1/2" or 2" pipe sizes. It is equipped with a union to accommodate installation in confined spaces. The unit contains two single pole double throw snap action switches and an adjustable, instantly recycling pneumatic retard. The switches are actuated when a flow of 8-10 gallons per minute or more occurs downstream of the device. These devices may be mounted in horizontal or vertical pipe. The unit has a 1" NPT fitting for threading into non-corrosive tee.			
522154	VSR-SFT	1" - 2" RESI-FLOW SWITCH "THREAD"	1
Vane Type - With Retard and "Glue-In" Union			
The Model VSR-SFG is a vane type waterflow switch for use on wet sprinkler systems using CPVC plastic fittings that use 1", 1-1/4", 1-1/2" or 2" pipe sizes. It is equipped with a union to accommodate installation in confined spaces. The unit contains two single pole double throw snap action switches and an adjustable, instantly recycling pneumatic retard. The switches are actuated when a flow of 0-10 gallons per minute or more occurs downstream of the device. These devices may be mounted on horizontal or vertical pipe. The unit has a 1" male fitting for gluing into a CPVC plastic tee.			
522152	VSR-SFG	1" - 2" RESI-FLOW SWITCH "GLUE"	1

POTTER

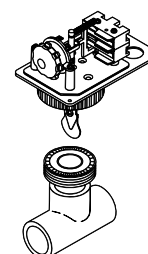
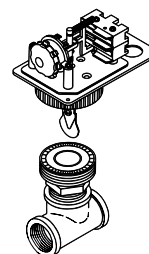
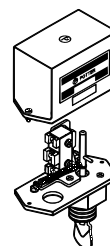
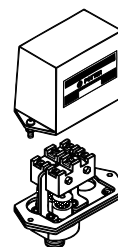
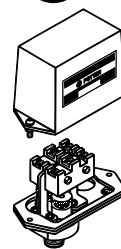

Tamper Switches

FFF Number	Mfg. Number	Description	Pack	POTTER
		<p>FLOW SWITCHES WITH RETARD Retard circuit allows minor surges in water flow without activating the alarm.</p> <p>Waterflow Alarm Switch with Retard For use in wet sprinkler systems with alarm check valves. The WFSR-F is a pressure operated switch with an adjustable instantly recycling pneumatic retard to prevent false alarms. Maximum system pressure of 175 PSI and factory adjusted to operate between 4 & 8 PSI on rising pressure.</p>		
522230	WFSR-F	ALARM SWITCH W/RETARD	1	
		<p>Vane Type - Threaded Connection For use in wet sprinkler systems with small diameter pipe that do not have an alarm check valve. Service pressure up to 250 PSI. Each unit contains two single pole, double throw, snap action switches and paddles for 1", 1-1/4", 1-1/2" and 2" pipe sizes.</p>		
522150	VSR-SF	1" IPS	1	
		<p>Vane Type - Saddle Connection For use on wet sprinkler systems with service pressures up to 450 PSI that do not have an alarm check valve. Each unit contains two single pole, double throw, snap action switches.</p>		
522141	VSR-F	2" IPS SADDLE - PNEUMATIC RETARD	1	
522142	VSR-F	2-1/2" IPS SADDLE - PNEUMATIC RETARD	1	
522143	VSR-F	3" IPS SADDLE - PNEUMATIC RETARD	1	
522145	VSR-F	4" IPS SADDLE - PNEUMATIC RETARD	1	
522147	VSR-F	6" IPS SADDLE - PNEUMATIC RETARD	1	
522148	VSR-F	8" IPS SADDLE - PNEUMATIC RETARD	1	
		<p>TAMPER SWITCHES</p> <p>Outside Screw & Yoke Switch Used to monitor the open position of an OS&Y type gate valve. Mounts to most OS&Y valves from 2" to 12", and some valves as small as 1/2".</p>		
522220	OSYS-U1	ONE S.P.D.T. CONTACT	5	
522225	OSYS-U2	TWO S.P.D.T. CONTACTS	5	
		<p>Post Indicator And Butterfly Switch Used to monitor the open position of valve types such as post indicator, butterfly, and others. Each unit contains two single pole, double throw contacts and is weatherproof as well as tamper resistant.</p>		
522250	PCVS-2	PIV / BUTTERFLY - DOUBLE CONTACT	1	
		<p>Supervisory Switch Designed to supervise sprinkler system control valves. Particularly useful for unusual conditions, such as non-rising stem valves.</p>		
522261	PTS-C	PLUG TYPE SWITCH-SINGLE CONTACT	1\	