

## Fittings

PFS Number	Mfg. Number	Description	Pack
		<p><b>ABBREVIATIONS:</b>                      ACP = Asbestos Cement Pipe                      DI = Ductile Iron                      FIP = Female Iron Pipe                      FLG = Flanged                      MJ = Mechanical Joint</p> <p><b>Mechanical Joint Fittings</b>                      For use with C-900 PVC, ductile iron, and asbestos cement pipe. Cast or ductile iron, cement lined, red primer or bituminous black coating. All necessary accessory packs are available separately.</p> <p><b>90° Elbows</b></p> <p>541004 4" MJ 1                      541006 6" MJ 1                      541008 8" MJ 1                      541010 10" MJ 1                      542004 4" MJ X FLG 1                      542006 6" MJ X FLG 1                      542008 8" MJ X FLG 1                      542010 10" MJ X FLG 1</p> <p><b>45° Elbows</b></p> <p>541014 4" MJ 1                      541016 6" MJ 1                      541018 8" MJ 1                      541020 10" MJ 1</p> <p><b>11-1/4° Elbows</b></p> <p>541034 4" MJ 1</p> <p><b>22-1/2° Elbows</b></p> <p>541024 4" MJ 1                      541026 6" MJ 1</p> <p><b>Tees</b></p> <p>541104 4" MJ 1                      541106 6" MJ 1                      541108 8" MJ 1                      541110 10" MJ 1                      542024 4" MJ X MJ X FLG 1                      542026 6" MJ X MJ X FLG 1</p> <p><b>Tees - Reducing</b></p> <p>Tees are read straight through and then outlet 1,2,3.</p> <p>541114 6" X 6" X 4" MJ 1                      541118 8" X 8" X 4" MJ 1                      541124 8" X 8" X 6" MJ 1                      541128 8" X 6" X 8" MJ 1                      541131 10" X 10" X 6" MJ 1                      541132 10" X 10" X 8" MJ 1                      542064 6" X 6" X 4" MJ X MJ X FLG 1                      542084 8" X 8" X 4" MJ X MJ X FLG 1                      542086 8" X 8" X 6" MJ X MJ X FLG 1</p>	

⊕ SIGMA\* / NAPCO\*

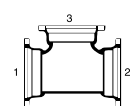
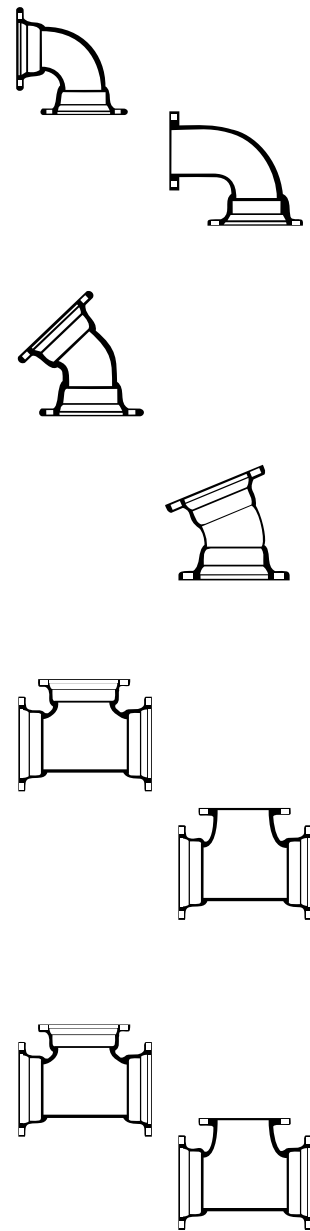

# Mechanical Joint Fittings

Section  
58

## Fittings

PFS Number	Mfg. Number	Description	Pack
<b>Reducers - Concentric</b>			
541074		6" X 4" MJ	1
541076		8" X 4" MJ	1
541078		8" X 6" MJ	1
541100		12" X 8" MJ	1
<b>Reducers - Small End Bell</b>			
Used to reduce a mechanical joint fitting or valve.			
542164		6" X 4" SPG X MJ	1
542184		8" X 4" SPG X MJ	1
542186		8" X 6" SPG X MJ	1
542188		10" X 6" SPG X MJ	1
542190		10" X 8" SPG X MJ	1
<b>Reducers - Large End Bell</b>			
Used to reduce C-900, ductile iron, or asbestos cement pipe for a smaller mechanical joint fitting or valve.			
542248		4" X 8" SPG X MJ	1
542268		6" X 8" SPG X MJ	1
<b>Caps</b>			
541144		4" MJ	1
541146		6" MJ	1
541148		8" MJ	1
541150		10" MJ	1
<b>Plugs</b>			
541156		6" MJ	1
541158		8" MJ	1
541160		10" MJ	1
<b>Sleeves - Short</b>			
For coupling DI, C900 and ACP machine end pipe.			
541054		4" MJ	1
541056		6" MJ	1
541058		8" MJ	1
<b>Sleeves - Long</b>			
For coupling DI, C900 and ACP machine end pipe.			
541064		4" MJ	1
541066		6" MJ	1
541068		8" MJ	1
541070		10" MJ	1
571072		12" MJ	1
<b>Adapters - Flanged</b>			
Used to transition from mechanical joint fittings to flanged.			
542104		4" MJ X FLG	1
542106		6" MJ X FLG	1
542108		8" MJ X FLG	1
542110		10" MJ X FLG	1

Σ SIGMA\* / NAPPCO\*

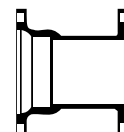
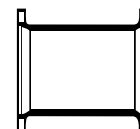
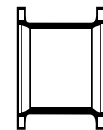
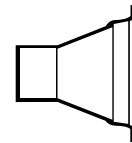
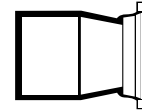
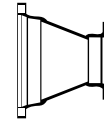

## Accessory Packs & Gaskets

PFS Number	Mfg. Number	Description	Pack
		<b>ACCESSORIES</b>	
		<b>MJ Accessory Packs</b> Used when joints are not required to be restrained. Each pack contains a ductile iron gland, a gasket, and all necessary nuts and bolts.	
543004		4"	1
543006		6"	1
543008		8"	1
543010		10"	1
		<b>MJ Retainer Gland Packs</b> Used when restrained joints are necessary or required. Each pack contains a ductile iron retainer gland, a gasket, and all necessary nuts and bolts.	
543024		4"	1
543026		6"	1
543028		8"	1
543030		10"	1
		<b>Mega-Lug Retainer Gland Packs - DI</b> Used when restrained joints are necessary or required on ductile iron pipe. Break off torque bolts make installation quick and correct every time. Each pack contains a ductile iron retainer gland, a gasket, break off torque bolts, and all necessary nuts and bolts.	
545354		4" FOR DI PIPE	1
545356		6" FOR DI PIPE	1
545358		8" FOR DI PIPE	1
545364		4" MEGA FLANGE ADAPTER	1
545366		6" MEGA FLANGE ADAPTER	1
545368		8" MEGA FLANGE ADAPTER	1
		<b>Mega-Lug Retainer Gland Packs - C-900</b> Used when restrained joints are necessary or required on C-900 PVC pipe. Break off torque bolts make installation quick and correct every time. Each pack contains a ductile iron retainer gland, a gasket, break off torque bolts, and all necessary nuts and bolts.	
545344		4" FOR C-900 PIPE	1
545346		6" FOR C-900 PIPE	1
545348		8" FOR C-900 PIPE	1

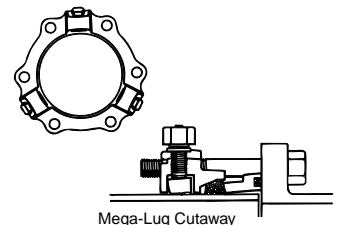
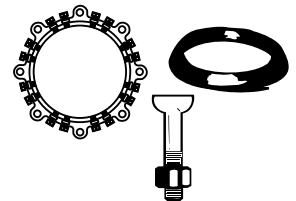
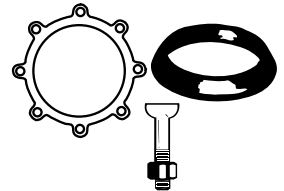

Mega-Lug Cutaway

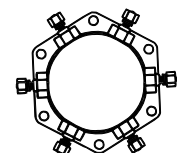

## Flange Packs, Gaskets & T-Bolts

PFS Number	Mfg. Number	Description	Pack
<p><b>Flange Packs</b> Used to connect two flanges. Each kit contains a gasket and all necessary nuts and bolts.</p>			
543202		2-1/2" - 150 LB.	1
543203		3" - 150 LB.	1
543204		4" - 150 LB.	1
543206		6" - 150 LB.	1
543208		8" - 150 LB.	1
543210		10" - 150 LB.	1
<p><b>MJ Gaskets</b></p>			
543034		4"	1
543036		6"	1
543038		8"	1
<p><b>Transition Gaskets - IPS</b> Allows mechanical joint fittings and glands to be used on IPS pipe.</p>			
543044		4"	1
543046		6"	1
543048		8"	1
<p><b>T-Bolt and Nut</b></p>			
543105		3/4" X 3-1/2"	1
<p><b>Glands</b></p>			
543014		4" MJ GLAND	1

Σ SIGMA<sup>®</sup> / NAPPCO<sup>®</sup>

